

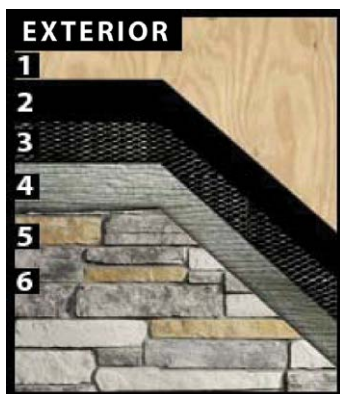

EXTERIOR INSTALLATION ON LIGHT WEIGHT CONCRETE BOARD

1. AIR SPACE BEHIND CEMENT BOARD
2. LIGHT WEIGHT CONCRETE BOARD
3. 2.5-POUND GALVANIZED METAL LATH
4. ADHESIVE / MORTAR
5. ROYAL STONE VENEER
6. MORTAR JOINT



EXTERIOR INSTALLATION ON PLYWOOD OR OSB

1. PLYWOOD OR OSB
2. WATER-RESISTANT BARRIER
3. 2.5-POUND GALVANIZED METAL LATH
4. ADHESIVE / MORTAR
5. ROYAL STONE VENEER
6. MORTAR JOINT



EXTERIOR INSTALLATION ON SLATS

1. 45-DEGREE SLATS, CENTRED AT 8"
2. WATER-RESISTANT BLACK PAPER
3. 2.5-POUND GALVANIZED METAL LATH
4. ADHESIVE / MORTAR
5. ROYAL STONE VENEER
6. MORTAR JOINT

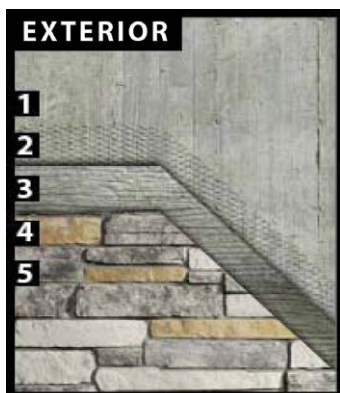

EXTERIOR INSTALLATION ON CONCRETE FOUNDATION

1. CONCRETE FOUNDATION CLEANED (NO OIL ON WALL)
2. 2.5-POUND GALVANIZED METAL LATH
3. ADHESIVE / MORTAR
4. ROYAL STONE VENEER
5. MORTAR JOINT



ROYAL STONES

Installation Guide

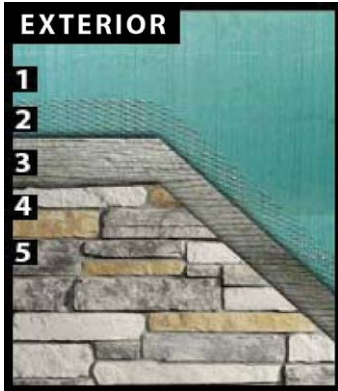

EXTERIOR INSTALLATION OVER RIGID INSULATION

1. RIGID INSULATION
 2. 2.5-POUND GALVANIZED METAL LATH
 3. ADHESIVE / MORTAR
 4. ROYAL STONE VENEER
 5. MORTAR JOINT
-

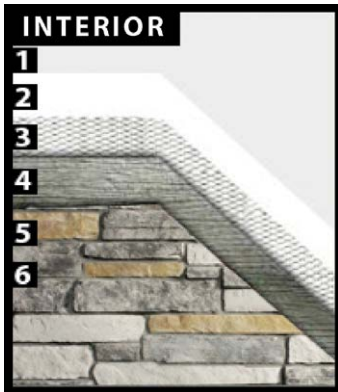

INTERIOR INSTALLATION ON DRYWALL

1. DRYWALL (GYPROCK)
 2. WEATHER RESISTANT BARRIER (WRB)
 3. 2.5-POUND GALVANIZED METAL LATH
 4. ADHESIVE / MORTAR
 4. ROYAL STONE VENEER
 5. MORTAR JOINT
-



INTERIOR INSTALLATION ON PLYWOOD

1. PLYWOOD / OSB
 2. WEATHER RESISTANT BARRIER (WRB)
 3. 2.5-POUND GALVANIZED METAL LATH
 4. ADHESIVE / MORTAR
 5. ROYAL STONE VENEER
 6. MORTAR JOINT
-

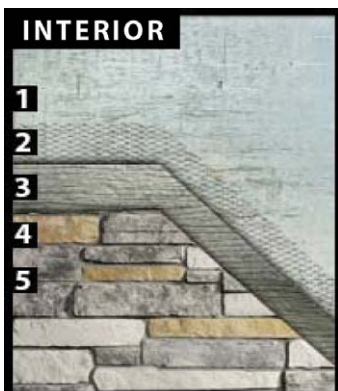

INTERIOR INSTALLATION ON LIGHT WEIGHT CONCRETE BOARD

1. LIGHT WEIGHT CONCRETE BOARD (DUROCK PERMABASE)
2. 2.5-POUND GALVANIZED METAL LATH
3. ADHESIVE / MORTAR
4. ROYAL STONE VENEER
5. MORTAR JOINT